



March 10, 2015

Mr. Ronald Fell, EMT-P President
Key Largo Volunteer Ambulance Corps
98600 Overseas Highway
Key Largo, FL. 33037

We are pleased to provide you with the following pricing, shop order and drawings for the purchase of new 2015 G4500 AEV Type III ambulance. Pricing is based on purchasing this unit off the Florida Sheriffs Contract Bid No. 15-11-0116, Specification #4 – Type III – 2 Wheel Drive (Diesel Engine, Dual rear wheel, Cab and Chassis).

PRICING:

- FSA base unit price per unit\$123,014.00
- Optional add on equipment\$ 23,330.00
- Total price per unit\$146,344.00
- Plus applicable taxes, tag, and title
- Include in above price: install customer provided radios, your present graphic package, transfer your Stryker Power Load from your present unit into this new unit. NOTE: Once the Stryker Power Load is removed from the present unit, the present unit will have a 2.5" x 5/8" x 72" section of the floor covering/sub floor missing. Price does not include adding back in a section of sub floor and all new floor covering to cover the hole.
- Air fare, transportation, and meals for two people to go to AEV factory for Pre-Engineering meeting and Final inspection of the completed unit.
- Above price includes delivery of the unit to your facility.
- Above price is good for 30 days.

Sincerely,

Bill Amador
Regional Sales Manager

212 Hickman Drive Sanford, FL 32771 * 407.339.6737 *Fax 407-339.8198

www.ETRLLC.com

SHOP ORDER

ETR, L.L.C.
 Bill Amador
 212 Hickman Drive
 Sanford, FL 32771
 407-339-6737
 407-339-8198

KEY LARGO FIRE RESCUE & EMS DISTRICT
 98600 OVERSEAS HIGHWAYS
 KEY LARGO, FL 33037

Exp. Date: 03/25/2015
Quote No: 10037-0021
 03/05/2015

| DESCRIPTION | QTY | ID |
|--|-----|-----|
| == ***** BID STANDARDS ***** - 0.000 02/07/11 == | 1 | AEV |
| < -- ORDER NUMBER ORDER NUMBER ??XX-???????????????????????????????? | 1 | AEV |
| Vehicle Quantity (Vehicles) | 1 | AEV |
| Quality Management System ISO 9001:2008 Registered | 1 | AEV |
| BODY NUMBER: | 1 | AEV |
| -- MICKEY BODY DUE DATE : | 1 | AEV |
| ACCOUNT MANAGER: Mikael Blevins | 1 | AEV |
| REFERENCE UNIT #: | 1 | AEV |
| RE-WRITE DATE : | 1 | AEV |
| SEAT BELT POSITIONS MODS | 1 | AEV |
| -- CAB SEAT BELT MOD: | 1 | AEV |
| -- Total: 2 Positions | 1 | AEV |
| -- REAR SEAT BELT MOD: | 1 | AEV |
| -- Total: 3 Positions | 1 | AEV |
| Revision Level: 0 - Zero - ORIGINAL VERSION | 1 | AEV |
| == *** G4500 - 14200 GM 159 Cut Chassis *** - 0.000 02/07/11 == | 1 | AEV |
| 2015 GM, G4500 Cutaway Diesel, 14200, 159" WB | 1 | AEV |
| -- Engine: 6.6 Duramax 6600 Turbo Diesel - G4500 SCR System | 1 | AEV |
| -- SCR System: G4500 Behind Rear Axle | 1 | AEV |
| -- Transmission: 6-Speed Automatic - MYD - OverDrive | 1 | AEV |
| -- Engine Block Heater: Part of YF2 Package, Not connected to Shoreline | 1 | AEV |
| -- GVWR: 14,200 pounds, FAWR: 4,600, RAWR: 9,600 | 1 | AEV |
| -- YF2 - Amb Prep Package - G4500 14,200 Cargo | 1 | AEV |
| -- Alternator: Dual 145amp, OEM | 1 | AEV |
| -- Throttle: OEM System thru Cruise Control | 1 | AEV |
| -- Rear Axle: 3.73 ratio with locking differential | 1 | AEV |
| -- Transmission Oil Cooler: External V14 | 1 | AEV |
| -- Brakes: 4-Wheel Anti Lock, 4-Wheel Disc | 1 | AEV |
| -- Stabilizer: Front Axle Mounted, OEM | 1 | AEV |
| -- Fuel tank capacity: 57 gal. | 1 | AEV |
| -- Shock Absorbers: Front OEM | 1 | AEV |
| -- Appearance Package: Chrome | 1 | AEV |
| -- Windshield Wipers: Intermittent | 1 | AEV |

| | DESCRIPTION | QTY | ID |
|---|--|-----|------------|
| | -- Mirrors, 2 , VelVac Euro-style, Pwr/Ht/Turn #716800 | 1 | AEV |
| | -- Daytime Running Lights: Included on Chassis OEM | 1 | AEV |
| | -- Tires: (6) Random Make, LT225/75R16E All Season Radials | 1 | AEV |
| | -- Tire Spare: To match other tires mounted on chassis | 1 | AEV |
| | -- Location: Shipped Loose | 1 | AEV |
| | -- Wheel Simulators: Phoenix installed over Steel Wheels, G3500/4500 | 1 | AEV |
| < | -- Exhaust System: with passenger side exit Relocated to be just behind rear wheels, 90 degrees to body sidewall. | 1 | AEV |
| | -- GM Cutaway Rear Sway Bar: OEM | 1 | AEV |
| | -- Power Windows & Door Locks, Pkg. | 1 | AEV |
| | -- CAB Seats: Capt....., Cloth, w/inboard arms, Dr & Pass | 1 | AEV |
| | -- Restraint System | 1 | AEV |
| | -- Radio, AM/FM/CD ETR, Stereo ,OEM | 1 | AEV |
| | -- Power Ports: (2) 12v Power Ports in Cab | 1 | AEV |
| | -- Air Conditioning: OEM Front - Manual | 1 | AEV |
| | -- Air Conditioning: HVAC Rear Connection Hook up | 1 | AEV |
| | -- Cab interior color: Medium Pewter | 1 | AEV |
| | -- Cab Floor: Black Rubberized Vinyl | 1 | AEV |
| | -- Cab Headliner: OEM | 1 | AEV |
| | -- Speed control & tilt steering wheel: OEM | 1 | AEV |
| | -- Tire Pressure Monitoring System: None | 1 | AEV |
| | == 172 x 95 Mod Body, G4500-14200 - 0.000 02/07/11 == | 1 | AEV |
| | BODY | 1 | AEV |
| < | -- ALL DIMENSIONS ON ORDER WILL HAVE A VARIABLE OF + OR - 1/4" Unless specified as a minimum dimension. | 1 | AEV |
| | Body, Module: Cut-away, 172 x 95 x 72" Interior Head Room - G | 1 | AEV |
| | -- Headroom: 74/72" Finished Interior - Ducted A/C | 1 | AEV |
| | -- | 1 | AEV |
| | -- Cab Extension: 10-inch - allows full OEM seat travel + 4" | 1 | AEV |
| < | -- Compartment Construction: STANDARD, Unless Specified Otherwise | 1 | AEV |
| | Sides and Back: .100 Polished Aluminum Diamond Plate | | |
| | Compartment Bottom: .125 Aluminum Sheet | | |
| | Compartment Ceiling: .090 Aluminum Sheet | | |
| < | -- Compt Floors: Sweep-out, even with bottom door jamb Unless Specified Otherwise. | 1 | AEV |
| | -- Compartment Ventilation - Austin Flap style #VT-2495-A01, STD | 1 | AEV |
| | -- Curbside Entry Door (CSE): 73.8 High x 31 Wide G4500 | 1 | AEV |
| | -- C/S Door Check : Double Action Gas Shock | 1 | AEV |
| | -- Door Swing Angle: Set just over 90 degrees | 1 | AEV |
| | -- Curbside Entry Door (CSE) Location: Standard, Rearward of M-7 Compt if Optioned | 1 | AEV |
| | -- Step Well, CURBSIDE Entry Door, 1-Step Diamond Plate | 1 | AEV |
| < | -- ILOS Light, Step Well: Kinequip #KML-W-SC, White LED, Chrome Bezel Light shall come on with CS door only. | 1 | AEV |
| | -- M-1 Compt (LF): 72 HR, 58.8" H x 18.6" W x 19.4" D w/M1a | 1 | AEV |
| < | -- Compartment Construction: STANDARD Diamond Plate | 1 | AEV |
| | Sides and Back: .100 Polished Aluminum Diamond Plate | | |
| | Compartment Bottom: .125 Aluminum Sheet | | |
| | Compartment Ceiling: .090 Aluminum Sheet | | |
| | -- Compartment Door Panel: Diamond Plate | 1 | AEV |

| | DESCRIPTION | QTY | ID |
|---|--|-----|-----|
| | -- Compartment Finish: Diamond Plate Standard | 1 | AEV |
| | -- Compartment Door Ventilation - small punched half moon Louvered Door | 1 | AEV |
| | -- Compt Floor: Sweep-out, even with bottom door jamb. | 1 | AEV |
| | -- Compartment Door: SINGLE DOOR, Forward hinged 2-point Latch | 1 | AEV |
| < | -- Light, Compt, M-1 (LF): Intertek Model No ZY-156-921 | 1 | AEV |
| | MTB Note: 1" Hole, Centered in Compartment ceiling | | |
| | -- Prep for 02 Lift: NONE | 1 | AEV |
| | -- M-1a Compt (LF Upper): 72 HR, 17.56" H x 18.6" W x 19.4" D | 1 | AEV |
| < | -- Compartment Construction: STANDARD Diamond Plate | 1 | AEV |
| | Sides and Back: .100 Polished Aluminum Diamond Plate | | |
| | Compartment Bottom: .125 Aluminum Sheet | | |
| | Compartment Ceiling: .090 Aluminum Sheet | | |
| | -- Compartment Door Panel: Diamond Plate | 1 | AEV |
| | -- Compartment Finish: Diamond Plate Standard | 1 | AEV |
| | -- Compartment Door Ventilation - small punched half moon Louvered Door | 1 | AEV |
| | -- Compt Floor: Sweep-out, even with bottom door jamb. | 1 | AEV |
| | -- Compartment Door: SINGLE DOOR, 1-point Latch | 1 | AEV |
| < | -- Light, Compt, M-1 (LF): Intertek Model No ZY-156-921 | 1 | AEV |
| | MTB Note: 1" Hole, Centered in Compartment ceiling | | |
| | -- M-2 Compt (LFM): 31.5" H x 44.5" W x 19.4" D | 1 | AEV |
| < | -- Compartment Construction: STANDARD Diamond Plate | 1 | AEV |
| | Sides and Back: .100 Polished Aluminum Diamond Plate | | |
| | Compartment Bottom: .125 Aluminum Sheet | | |
| | Compartment Ceiling: .090 Aluminum Sheet | | |
| | -- Compartment Door Panel: Diamond Plate | 1 | AEV |
| | -- Compartment Finish: Diamond Plate Standard | 1 | AEV |
| | -- Compt Floor: Sweep-out, even with bottom door jamb. | 1 | AEV |
| < | -- Bio-Waste: Diamond Plate Closeout for Bio in A/A | 1 | AEV |
| | Dogleg for interior access bio-waste. 14" W x 13"H and compartment depth less 2". | | |
| | -- Doors, Compartment, DOUBLE DOORS (std) | 1 | AEV |
| < | -- M-2 Shelf, Adjustable, Ext: .125 Alum, 2" Upward lip | 1 | AEV |
| | Shelf will be positioned high for mounting of inverter and other electrical components. | | |
| | -- Shelf Bracket: CPI 90 Deg with Slotted Holes | 1 | AEV |
| < | -- Light, Compt, LED, M-2 (LFM): Intertek Model No ZY-156-LEDC, ILOS | 1 | AEV |
| | MTB Note: 1" Hole, Centered in Compartment ceiling | | |
| | -- Condenser, 12V: ACC, Dual Fan, Under Cubeside Step well | 1 | AEV |
| | -- Condenser Brackets: Under stepwell, angled down | 1 | AEV |
| | -- Conduit No 2: 1 1/2", with pull wire | 1 | AEV |
| | -- CONDUIT ORIGINATION POINT: Electrical Circuit board cabinet | 1 | AEV |
| | -- CONDUIT TERMINATION POINT: Behind Driver's seat | 1 | AEV |
| | -- Standard Conduit: 1-1/2", with pull wire | 1 | AEV |
| | -- CONDUIT ORIGINATION POINT: M1A compartment | 1 | AEV |
| | -- CONDUIT TERMINATION POINT: Behind A/A Board (Panel) | 1 | AEV |
| | -- | 1 | AEV |
| < | -- M-3 Compt (LR): 58.5" H x 33.1" W x 19.4 D | 1 | AEV |
| | WITH 58.5" HIGH M3, THIS WILL NARROW THE TELEMETRY AREA & LP WILL PROBABLY NOT FIT | | |
| | NOTE: Top Section of M3 compartment will be inside/outside access from interior cabinet C and then there will be a box off in compartment for interior cabinet E and then storage below box off. | | |
| < | -- Compartment Construction: STANDARD Diamond Plate | 1 | AEV |
| | Sides and Back: .100 Polished Aluminum Diamond Plate | | |
| | Compartment Bottom: .125 Aluminum Sheet | | |

| DESCRIPTION | QTY | ID |
|--|-----|-----|
| Compartment Ceiling: .090 Aluminum Sheet | | |
| -- Compartment Door Panel: Diamond Plate | 1 | AEV |
| -- Compartment Finish: Diamond Plate Standard | 1 | AEV |
| < -- Compartment Ventilation - Compartment Ceiling O O O O | 1 | AEV |
| <p>MTB NOTE: Specified compartments shall have a hat channel at the ceiling level. The hat channel shall run to no closer than 1" from the compartment side walls to allow for air exchange. Hidden from view, shall be two to three, (4") holes above the hat channel to exhaust the compartment air when the door is closed to allow it to close with minimal effort.</p> | | |
| -- Compt Floor: Sweep-out, even with bottom door jamb. | 1 | AEV |
| -- Compartment Door: SINGLE DOOR, 1-point Latch | 1 | AEV |
| -- Shelf, Adjustable, Ext: .125 Aluminum, 2" Upward Lips | 1 | AEV |
| -- Shelf Bracket: CPI 90 Deg with Slotted Holes | 1 | AEV |
| < -- Light, Compt, LED, M-3 (LR): Intertek Model No ZY-156-LEDC, ILOS | 1 | AEV |
| <p>MTB Note: 1" Hole, Centered in Compartment ceiling</p> | | |
| < -- Shelf, Fixed, Ext: .125 Aluminum, 2" Upward Lips | 1 | AEV |
| <p>Fixed shelf location at bottom of Interior Cabinet C I/O access</p> | | |
| -- M-5 Compt (RR): 72 HR, 79.8" H x 17.6" W x 21" D | 1 | AEV |
| < -- Compartment Construction: STANDARD Diamond Plate | 1 | AEV |
| Sides and Back: .100 Polished Aluminum Diamond Plate | | |
| Compartment Bottom: .125 Aluminum Sheet | | |
| Compartment Ceiling: .090 Aluminum Sheet | | |
| -- Compartment Door Panel: Diamond Plate | 1 | AEV |
| -- Compartment Finish: Diamond Plate Standard | 1 | AEV |
| < -- Compartment Ventilation - Compartment Ceiling O O O O | 1 | AEV |
| <p>MTB NOTE: Specified compartments shall have a hat channel at the ceiling level. The hat channel shall run to no closer than 1" from the compartment side walls to allow for air exchange. Hidden from view, shall be two to three, (4") holes above the hat channel to exhaust the compartment air when the door is closed to allow it to close with minimal effort.</p> | | |
| -- Compt Floor: Sweep-out, even with bottom door jamb. | 1 | AEV |
| -- Compartment Door: SINGLE DOOR, Forward hinged 2-point Latch | 1 | AEV |
| -- M-5 Shelves, (3) Adjustable, Ext: .125 Aluminum, Partial Width 2" lips upward | 3 | AEV |
| -- Shelf Bracket: CPI 90 Deg with Slotted Holes | 3 | AEV |
| < -- M5 Divider, Vertical, Full compartment height, alum, Fixed | 1 | AEV |
| <p>Notch divider so light shines on both sides</p> | | |
| < -- Retainer Bar: Installed In Exterior Compartment Each | 1 | AEV |
| <p>NOTE: installed from Wall #1 to divider in upper section of compartment.</p> | | |
| < -- Strap: 2" Webb, w/ Chrome Metal Seatbelt buckle | 1 | AEV |
| <p>This strap is to secure things from moving while the vehicle is in motion, it is not a tested device and is not designed to be a crash stable securing device.</p> | | |
| -- 2" Footman Loops: Locate back from jamb | 1 | AEV |
| -- Light, Compartment: Whelen 4" Round LED #20C0CDCR, ILOS | 1 | AEV |
| < -- Recess Mount, In Rubber Grommet | 1 | AEV |
| <p>MTB Note: 4 1/2" Light hole centered in compartment ceiling</p> | | |
| <p>Notch divider so light shines on both sides</p> | | |

| DESCRIPTION | QTY | ID |
|--|-----|-----|
| -- M-7 Compt (RF): 72 HR, 46.6" H x 25.25" W, I/O to ALS | 1 | AEV |
| -- Compartment Door: SINGLE DOOR, 1-point Latch | 1 | AEV |
| -- Light, Compt, M-7 (RF): NONE | 1 | AEV |
| -- M-8 Drawer (RF): Batt, 164, 12.1" H x 25.25" W x 21.4" D | 1 | AEV |
| < -- Compartment Construction: STANDARD Diamond Plate | 1 | AEV |
| Sides and Back: .100 Polished Aluminum Diamond Plate | | |
| Compartment Bottom: .125 Aluminum Sheet | | |
| Compartment Ceiling: .090 Aluminum Sheet | | |
| -- Compartment Door Panel: Diamond Plate | 1 | AEV |
| -- Compartment Finish: Diamond Plate Standard | 1 | AEV |
| -- Drawer Front: 2-point latch | 1 | AEV |
| -- | 1 | AEV |
| -- Rear Access Doors: 46 3/4" Wide x 60 5/8" High | 1 | AEV |
| WELDING - CELL 1 | 1 | AEV |
| < Fuel Fill: CPI C1045, Open Housing, Polished Bezel - (Std) | 1 | AEV |
| AEV Part No: HOUS-1045 | | |
| Urea Fill: CPI FG4503-1-163 Inlet Housing | 1 | AEV |
| BODY PROTECTION AND TRIM PACKAGE: G3/4500 | 1 | AEV |
| -- Bumper, Rear: HD Alum Framed w/DP pontoon covers | 1 | AEV |
| -- Step, Center: 2" x 7" Grip strut, flip-up | 1 | AEV |
| < -- Fenders, Rear: Rubber Extruded, Black | 1 | AEV |
| MTB #7215439 | | |
| -- Skirt Rails: Polished Aluminum Diamond Plate | 1 | AEV |
| < -- Corner Caps: 17.3" High, Alum Diamond Plate | 1 | AEV |
| If there is a body drop, add the appropriate height to Corner Caps. | | |
| < -- Front Stone Guards: 17.3" High, Alum Diamond Plate | 1 | AEV |
| If there is a body drop, add the appropriate height to Stone Guards. | | |
| -- Rear Kick Plate: Polished Aluminum Diamond Plate | 1 | AEV |
| -- Recessed Tag Area: Polished Aluminum Diamond Plate | 1 | AEV |
| -- Location: Centered in the kick plate | 1 | AEV |
| -- Tag Light: Kinequip LED #132703C | 1 | AEV |
| -- Rear Deflector: NONE | 1 | AEV |
| < (2) Rear Door Hold Opens: Grabber Style, each door | 1 | AEV |
| AEV Part No: HOLD-16N (2) | | |
| -- | 1 | AEV |
| Running Boards: Diamond Plate, G3/4500 | 1 | AEV |
| -- Mud Flaps Front: NONE | 1 | AEV |
| < -- Mud Flaps Rear: Modular, Rubber | 1 | AEV |
| (2) AEV Part# FLAP-M02 | | |
| EXTERIOR LIGHTING / HEAT/AC / INSULATION - CELL 2 | 1 | AEV |
| CORNER CAP LED ICC/WARNING LIGHTS | 1 | AEV |
| -- Front Corner Cap LED ICC/Warning Lights: Warnings RED/WHITE | 1 | AEV |
| < -- Front Center ICC Lts: (3) AMBER Kinequip LED No 112401A, | 1 | AEV |
| Switch w/ Headlights. | | |
| -- Front ICC Lt Guards: NONE | 1 | AEV |
| -- Rear Corner Cap LED ICC/Warning Lights: Warnings RED/AMBER | 1 | AEV |
| < -- Rear Center ICC Lts: (3) RED Kinequip LED No 112401R | 1 | AEV |
| Switch w/ Headlights | | |
| -- Rear ICC Lt Guards: NONE | 1 | AEV |

| DESCRIPTION | QTY | ID |
|---|-----|-----|
| -- ICC Warning Lights Switched: Primary Only | 1 | AEV |
| LED Patient on Board, Exterior, NONE | 1 | AEV |
| LED Door Panel Warning, Interior, NONE | 1 | AEV |
| Underbody ("BUM") Lights : NONE | 1 | AEV |
| Tail Lights, Whelen LED Combinations , ILOS, Non FORD chassis | 1 | AEV |
| < -- Side Marker Lights: (2) RED Kinequip LED No 112401RD Switch w/ Headlights. | 1 | AEV |
| -- Whelen 900 Series: Tail Lights | 1 | AEV |
| -- Flanges: (6) Chrome for above 900 Series Tail lights | 1 | AEV |
| -- Stop/Tail, Whelen 900 Series, LED, Pair, Maximum Populated | 1 | AEV |
| -- Turn, Whelen 900 Series, LED, Pair | 1 | AEV |
| < -- Back up, Whelen 900 Series, Halogen, Pair | 1 | AEV |
| NOTE: Whelen 900 LED Back Up Lights are not Available from Whelen. | | |
| Patient Area Turn and Stop Light Indicator: None | 1 | AEV |
| < Third (3rd) Brake Light: Kinequip KFL-3BLO1 LED | 1 | AEV |
| LOCATION: Over Rear Access Doors. | | |
| Do not cut traditional hole. | | |
| Just screw and wire holes required. | | |
| -- Light is to steady burn, no flash | 1 | AEV |
| SCENE/FLOOD LIGHTS (LED-24 Series) | 1 | AEV |
| -- Left Scene Lights: (2) LED-24, Whelen 900 | 1 | AEV |
| -- Left Flood Activate: Left Flood Switch | 1 | AEV |
| -- Right Scene Lights: (2) LED-24, Whelen 900 | 1 | AEV |
| -- Right Flood Activate: Right Flood Switch and open CSE Door | 1 | AEV |
| -- Rear Load Lights: (2) LED-24, Whelen 900 | 1 | AEV |
| -- Activate: Rear Flood Switch, Reverse and Lead RA Door | 1 | AEV |
| HEAT AND AC | 1 | AEV |
| < AC Evap: ACC HVAC Ducted in Ceiling (AC Heat Unit) - Vert..... Mounted Behind the Attendant Seat Base | 1 | AEV |
| -- AC Evaporator Location: Behind Attendant Seat on the floor | 1 | AEV |
| -- Condensation Drain Pan: Internal ABS | 1 | AEV |
| -- A/C Condenser: O.E.M. | 1 | AEV |
| -- AC Hoses: GoodYear Galaxy | 1 | AEV |
| -- Heater Hoses: EPDM - Nomex Rubber (per Ford QVM) | 1 | AEV |
| -- Side Plenum Grille, Return Air: Stamped Powder Coated Steel | 1 | AEV |
| -- Filter, Washable Carbon Pre-Filter | 1 | AEV |
| -- AC COMPRESSOR: Tee into O.E.M. | 1 | AEV |
| -- Ducted AC Delivery: insulated & foil wrapped, 10 registers | 1 | AEV |
| -- AC Control: Heat or AC and Fan Speed selector switches | 1 | AEV |
| Espar Heater System: None | 1 | AEV |
| CEILING PANELS : Gloss Mica over 1/4" hard plywood | 1 | AEV |
| -- Dome Lts, LED K15: Kinequip, (4) Streetside, (4) Curbside | 1 | AEV |
| < -- Timer: Electronic, 15 Min with momentary switch Constant Hot Located on curbside wall at head of squad bench. | 1 | AEV |
| -- Timer to Power: Street side DOMES, High intensity | 1 | AEV |
| -- IV Hook No 1: Hook 07 w/ Velcro bag stabilizer - STD | 1 | AEV |
| -- LOCATION: Over head/chest area, primary patient on COT | 1 | AEV |
| -- IV Hook No 2: Hook 07 w/ Velcro bag stabilizer - STD | 1 | AEV |
| -- LOCATION: Over head/chest area, secondary patient on S/B | 1 | AEV |
| < -- Recessed C/S Grab Rail, ceiling: 1.25 Dia..... 3 pt, 72in, Gray Antimicrobial Grab Rail will be recessed in a ABS pan. AEV Part No: RAIL-BK72CS | 1 | AEV |
| Insulation PKG: | 1 | AEV |

| | DESCRIPTION | QTY | ID |
|---|---|-----|-----|
| | -- Insulation: Circumferential PKG, Reflective w/ Air cell core | 1 | AEV |
| | -- Insulation: Entry Door, Reflective w/ Air cell core | 1 | AEV |
| < | -- Insulation: Floor, 1/2" Block Foam | 1 | AEV |
| | Generation 7 Floor Design | | |
| | -- Insulation: Walls/Ceiling, Additional : NONE | 1 | AEV |
| | -- Stepwell Insulation: None | 1 | AEV |
| | -- Front Light Bar: NONE | 1 | AEV |
| | -- Rear Light Bar: NONE | 1 | AEV |
| | LED WARNING LT SYSTEM - G4500 - 14200 LTD | 1 | AEV |
| < | -- Flasher: None, All Super LED's Are Programmable | 1 | AEV |
| | Fast, Alternate within each fixture, Random Flash unless otherwise specified. | | |
| | -- Flash Pattern: None, Internal Light Head Flasher | 1 | AEV |
| | -- Warning Light SWITCH: center console, Primary / Secondary | 1 | AEV |
| | -- Standard Pattern Table | 1 | AEV |
| | -- Pattern #1: SignalAlert75 | 1 | AEV |
| | -- Mirror Lights: NONE | 1 | AEV |
| | -- (2) Grille Lights: Whelen TIRLIN3, LED, Chrome Hsg | 1 | AEV |
| | -- Program #25 - Steady Burn, Flash thru Flasher | 1 | AEV |
| | -- Lights: (2) Whelen TIRLIN3, RED LED, Chrome Hsg | 1 | AEV |
| | -- Red LED | 1 | AEV |
| | -- Lens color for Above LED Light to be: Clear | 1 | AEV |
| | -- Additional Grille TIR-Lights: NONE | 1 | AEV |
| | -- (2) Front Intersection Red Lts: Whelen 700, LED (Super LED) | 1 | AEV |
| | -- Flanges: (2) 700-Chrome Flange for lights above | 1 | AEV |
| | -- Lights: (2) Whelen 700, Super RED LED/CLEAR LENS, Programmable ILOS | 1 | AEV |
| | -- Lens color for Above LED Light to be: Clear | 1 | AEV |
| | -- LED Lights: Programmable, Pair of Lights | 1 | AEV |
| | -- LED Color for Above 700 Super LED Pair: Red | 1 | AEV |
| | -- (1) Center Front Warning Light : Whelen 900 (Super LED) | 1 | AEV |
| | -- Flange: (1) 900-Chrome Flanges for light above | 1 | AEV |
| | -- Light: Whelen 900, Super WHITE LED/CLEAR LENS, Programmable ILOS | 1 | AEV |
| | -- Lens color for Above LED Light to be: Clear | 1 | AEV |
| | -- LED Color for Above 900 Super LED: WHITE | 1 | AEV |
| | -- LED Lights: Programmable, Single Light | 1 | AEV |
| | -- (2) Front Warning Lts: Whelen 900, (Super LED) | 1 | AEV |
| | -- Flanges: (2) 900-Chrome Flanges for lights above | 1 | AEV |
| | -- Light: Whelen 900, Super RED LED/CLEAR LENS, Programmable ILOS | 2 | AEV |
| | -- Lens color for Above LED Light to be: Clear | 2 | AEV |
| | -- LED Color for Above 900 Super LED: RED | 2 | AEV |
| | -- LED Lights: Programmable, Single Light | 2 | AEV |
| | -- (4) Side Warning Lts: Whelen 900, (Super LED) | 1 | AEV |
| | -- Flanges: (4) 900-Chrome Flanges for lights above | 1 | AEV |
| | -- Light: Whelen 900, Super RED LED/CLEAR LENS, Programmable ILOS | 4 | AEV |
| | -- Lens color for Above LED Light to be: Clear | 4 | AEV |
| | -- LED Color for Above 900 Super LED: RED | 4 | AEV |
| | -- LED Lights: Programmable, Single Light | 4 | AEV |
| | -- Rear Intersection Lights, : NONE | 1 | AEV |
| | -- (2) Rear Warning Lts: Whelen 900, (Super LED) ilos | 1 | AEV |
| | -- Flanges: (2) 900-Chrome Flanges for lights above | 1 | AEV |
| | -- Location: REAR, (1) in EACH Upper outer corner. | 1 | AEV |
| | -- Light: Whelen 900, Super RED LED/CLEAR LENS, Programmable ILOS | 2 | AEV |
| | -- Lens color for Above LED Light to be: Clear | 2 | AEV |
| | -- LED Color for Above 900 Super LED: RED | 2 | AEV |
| | -- LED Lights: Programmable, Single Light | 2 | AEV |
| | -- Additional Rear Warning Lights: NONE | 1 | AEV |
| | -- (1) Rear Center Warning Lt: Whelen 600, (Super LED) | 1 | AEV |

| | DESCRIPTION | QTY | ID |
|---|---|----------|------------|
| < | -- Flange: (1) 600-Chrome Flanges for lights above LITE-6EFLANG | 1 | AEV |
| | -- Light: Whelen 600, Super AMBER LED/CLEAR LENS, Program ILOS | 1 | AEV |
| | -- Lens color for Above LED Light to be: Clear | 1 | AEV |
| | -- LED Color for Above 600 Super LED: AMBER | 1 | AEV |
| | -- LED Lights: Programmable, Single Light | 1 | AEV |
| | -- Additional Kick Plate Lts, On Rear : NONE | 1 | AEV |
| | -- LED Program Switch : NONE | 1 | AEV |
| | ELECTRICAL - CELL 3 | 1 | AEV |
| | -- Customer Supplied Part(s) : NONE | 1 | AEV |
| | -- Flasher, Headlight: NONE | 1 | AEV |
| < | Hand Held Spot Light: None Not Require by KKK-F | 1 | AEV |
| | Batteries: 2 - Battery System - G3/4500 Only | 1 | AEV |
| < | -- Battery Make: (2) Random Make, Min 750 CCA / 65 AHR Battery Brand must match. | 1 | AEV |
| | -- Batt Loc: (T3) (1) Underhood, Remainder Batt M-8 | 1 | AEV |
| < | -- Battery Switch: Cole Hersee 2484-16 Paddle, T3GM Driver seat base Cole Hersee Paddle style battery switch powers up and shuts down the CONVERSION only! Chassis related circuits shall remain wired in the O.E.M. configuration per Ford QVM Bulletin No 63. LOCATION: Side of drivers' seat base. With Face Plate LABEL Refer to Console for Exact Batt Sw Location. | 1 | AEV |
| | Dash Light : NONE | 1 | AEV |
| | POWER Door Locks: Module Doors - Full Mod - GM | 1 | AEV |
| < | -- Door Locks, Tied into OEM System Module power locks are tied to the Chassis power lock system | 1 | AEV |
| | -- DrLkSw: SPDT Momentary, (1) by C/S and (1) by Rr Dr | 1 | AEV |
| < | -- OEM Key Fob: Included w/Chassis Unlock Mod Doors Must also operate the Module Power Door Locks Optioned. | 1 | AEV |
| < | -- Door Lock Switches : Integrated in Interior Entry door Handles AEV part (2) HAND-ILS AEV Part No: SWIT-32L AEV Part No: BOOT-01 | 1 | AEV |
| | -- ONLY the following doors shall have power door locks: | 1 | AEV |
| | -- Electric Door Lock: (M-1) Left Front Compartment | 1 | AEV |
| | -- Electric Door Lock: (M-2) Left Middle Compartment | 1 | AEV |
| | -- Electric Door Lock: (M-3) Left Rear Compartment | 1 | AEV |
| | -- Electric Door Lock: Rear Access Doors | 1 | AEV |
| | -- Electric Door Lock: (M-5) Right Rear Compartment | 1 | AEV |
| | -- Electric Door Lock: Curbside Access Door | 1 | AEV |
| | -- Electric Door Lock: (M-7) Right Front Compt | 1 | AEV |
| < | -- Remote Keypad #1: Installed MTB to cut mounting holes per provided drawing. | 1 | AEV |
| | -- Location: By Curbside Door | 1 | AEV |
| < | -- Door Unlock Switch, Momentary, Exterior, hidden AEV Part No: SWITCH-32L | 1 | AEV |

| DESCRIPTION | QTY | ID |
|---|-----|-----|
| AEV Part No: BOOT-01 | | |
| NOTE: Installation of Remote Door Lock Switch feature may increase likelihood of unauthorized entry into vehicle. By checking this option, purchaser further agrees to hold AEV or chassis manufacturer harmless for any loss of vehicle or contents caused by unlawful access. | | |
| -- Location: Front Grille/Bumper Area | 1 | AEV |
| < -- Cam Sys - Single Exterior White Camera Pkg To Consist of: AEV CAMR-KIT1ASA 7" Monitor VCMS140I fixed position Exterior white camera over back doors Backup Camera Cable (50Ft) Camera Adapter | 1 | AEV |
| -- Monitor Mount : ABS Housing, Fixed Position | 1 | AEV |
| Circuit Board: RMR Rail System, W/ LED Diagram GM | 1 | AEV |
| -- Master Switch: Front Only | 1 | AEV |
| -- Circuit Protection, 12V: Blade Breaker - Manual-reset | 1 | AEV |
| -- Sequencer/Load manager: NONE | 1 | AEV |
| -- Ind Light Flasher: Thru 14S Flasher Unit | 1 | AEV |
| < -- Console, Engine Cover: OEM, Plus Vac Formed ABS Cap-GM Battery Switch to be located on right side of Driver's Seat base. | 1 | AEV |
| -- F3 SWITCH PANEL: 1-Level ABS w/ OEM Eng cover Console | 1 | AEV |
| -- | 1 | AEV |
| -- CHARGING SYSTEM GAUGE PACKAGE: None Required | 1 | AEV |
| -- Engraved LOGO: AEV TraumaHawk | 1 | AEV |
| -- Indicator Light: AMBER Compt Open" light | 1 | AEV |
| -- Flashing light: Activate w/ ANY compartment door switch. | 1 | AEV |
| -- Indicator Light: GREEN "Amb Pwr" light | 1 | AEV |
| -- Steady burn light: Activate with Conversion power switch | 1 | AEV |
| -- Indicator Light: RED "Door Ajar" light | 1 | AEV |
| -- Flashing light: Activate w/ ANY Mod entry door switch. | 1 | AEV |
| -- Door/Compartment Ajar Buzzer: None | 1 | AEV |
| < -- Console, radio, add-on, in cab Room for 2 radio's only. | 1 | AEV |
| -- Drink Holders for Additional Console, Big Gulp Size | 1 | AEV |
| -- Drink Holder Location: Rear | 1 | AEV |
| < -- See Pics on file of last unit | 1 | AEV |
| NOTE: I do not have photos to know exact layout. | | |
| -- Siren: Whelen, 295SLSA1, Standard G3/4500 | 1 | AEV |
| -- Location, Siren Head: Front of engine cover Console | 1 | AEV |
| < -- Siren / Horn Switch: In Cab Console | 1 | AEV |
| This switch shall select horn ring output: Siren Functions OR O.E.M. Horn | | |
| Back-up Alarm: Standard | 1 | AEV |
| -- Cut Off Switch: Auto reset ,momentary style | 1 | AEV |
| < Ground Straps, Module to Frame: (Qty 4) Braided | 1 | AEV |
| Grind/Clean each ground site on the O.E.M. frame to bare steel. | | |
| Use 3/8" - UNC x 1 1/2", Grade 8 hex head bolts, Nuts, and external tooth lock washers. Tighten to minimum 20 Ft/Lb. | | |
| < Inverter : Vanner 20-1050 CUL-DC - Full Mod AEV Part No: INVE-1050DC | 1 | AEV |
| -- Portable Equip Charging Circuits: Included in Inverter | 1 | AEV |
| -- PREWIRE LOCATION: (1)Cab Console, (1) Behind A/A | 1 | AEV |

| DESCRIPTION | QTY | ID |
|---|-----|------------|
| < -- Portable Equip Pwr Source: Ignition and/or Shoreline Reference 3.7.7.2 and Figure 7 in KKK-A-1822E | 1 | AEV |
| -- Battery Charger/Conditioner: 55A - Built into Inverter | 1 | AEV |
| -- Built-in Battery Charger: Enable - Wire to Batteries | 1 | AEV |
| -- Inverter Location: M-1A (ULF) Compartment | 1 | AEV |
| Low Voltage Indicator: Amber with Buzzer | 1 | AEV |
| COMMUNICATION RADIO(S) RELATED | 1 | AEV |
| -- | 1 | AEV |
| RADIO POWER | 1 | AEV |
| -- Radio Power No 1: 30A with Buss bar | 1 | AEV |
| -- Radio Power Source: Battery Switch Hot | 1 | AEV |
| -- LOCATION: Behind Passenger's Seat | 1 | AEV |
| -- Radio Power No 2: 30A with Buss bar | 1 | AEV |
| -- Radio Power Source: Battery Switch Hot | 1 | AEV |
| -- LOCATION: Behind Action Area Board | 1 | AEV |
| ANTENNA LEADS | 1 | AEV |
| -- Coaxial Cable, No 1: Type RG-58U, No connectors | 1 | AEV |
| < -- ORIGINATION POINT: Roof Port No 1 | 1 | AEV |
| Roof Port No 1 is lined up with the edge of the curbside entry door, and centered side to side as possible | | |
| -- Port Plate: None - Access thru center upholstery panel | 1 | AEV |
| -- TERMINATION POINT: Behind Passenger's seat w/ 36" Tail | 1 | AEV |
| -- Patient Area Radio : None | 1 | AEV |
| 125V SHORE LINE AND OUTLETS | 1 | AEV |
| -- | 1 | AEV |
| -- Shore Line Inlet: 20A Twistloc, Pass-Seymour, ILOS | 1 | AEV |
| -- Inlet location: Aft of Left Front compartment | 1 | AEV |
| -- | 1 | AEV |
| -- **125 Volt OUTLETS** | 1 | AEV |
| < -- 125 VAC Outlet, No 1: 15A, Hospital Grade, IVORY | 1 | AEV |
| All 125 VAC outlets shall be back lighted when power is applied to the outlet. | | |
| -- LOCATION: Action Area, standard location | 1 | AEV |
| -- Outlet mounting ORIENTATION: Vertical | 1 | AEV |
| -- 125 VAC Outlet, No 2: 15A, Hospital Grade, IVORY | 1 | AEV |
| -- LOCATION: RF ALS, (See Drawing) | 1 | AEV |
| -- Outlet mounting ORIENTATION: Vertical | 1 | AEV |
| -- **INTERIOR 12 Volt OUTLETS** | 1 | AEV |
| -- 12V Outlet, No 1: Power Point Double Outlet- Wire thru Med Isolator | 1 | AEV |
| -- LOCATION: Action Area, standard location | 1 | AEV |
| -- Outlet mounting ORIENTATION: Vertical | 1 | AEV |
| -- Power Source: Medical Isolator , Batt Sw Hot | 1 | AEV |
| -- 12V Outlet, No 3: Power Point - Wire thru Med Isolator | 1 | AEV |
| -- LOCATION: RF ALS, (See Drawing) | 1 | AEV |
| -- Outlet mounting ORIENTATION: Vertical | 1 | AEV |
| -- Power Source: The SAME as outlet No 1 | 1 | AEV |
| Siren: Whelen, 295SLSA1, Standard G3/4500 | 1 | AEV |
| -- Location, Siren Head: Front of engine cover Console | 1 | AEV |
| < -- Siren / Horn Switch: In Cab Console | 1 | AEV |
| This switch shall select horn ring output: Siren Functions OR O.E.M. Horn | | |
| Speaker #1, UnderBmpr, dual, G-Van (SA6012 | 1 | AEV |
| Air Horn System: BUELL | 1 | AEV |
| < -- Air Horns ACTIVATION: Single Foot Switch / Solenoid Valve N | 1 | AEV |
| Foot switch located on drivers side.\par AEV Part No: SWIT-12A AEV Part No: VALV-01 | | |

| DESCRIPTION | QTY | ID |
|---|-----|-----|
| -- Air Tank Mounted to Frame Rail | 1 | AEV |
| -- Emergency Master Hot | 1 | AEV |
| -- Compressor: Buel #6540, 20% Oil less Intermittent Duty | 1 | AEV |
| -- Compressor Location: M2 Compartment | 1 | AEV |
| < -- Air Horn Location: Through Front Bumper, G3500/4500 Thru the front bumper. | 1 | AEV |
| -- Left Air Horn: 12" Strombos Horn, Chrome, No 1062 (396 Hz) | 1 | AEV |
| -- Right Air Horn: 10" Strombos Horn, Chrome, No 1061 (493 Hz) | 1 | AEV |
| CABINET SHOP - Modular | 1 | AEV |
| < ALL DIMENSIONS ON ORDER WILL HAVE A VARIABLE OF + OR - 1/4" Unless specified as a minimum dimension. | 1 | AEV |
| < BULKHEAD PANELS: See Station 5 See Station 5 portion of shop order to find DOOR info. | 1 | AEV |
| Mica Color: Gloss White | 1 | AEV |
| Polycarbonate Type/Color: Lexan - GRAY | 1 | AEV |
| -- Polycarbonate Handles: Full Length Extruded | 1 | AEV |
| Attendant Seat: EVS, Vacuum Form, 3-Point Seat | 1 | AEV |
| -- Attendant Seat: EVS, Light Gray, Vacuum Form, 3-Point Seat | 1 | AEV |
| < -- BASE: Swivel base for EVS Seat Option Mounted to leave room for suction canister storage | 1 | AEV |
| -- Attendant Seat, Armrests, BOTH LEFT and RIGHT ARMS | 1 | AEV |
| AC CABINET: Evaporator, Std Location Behind Att Seat | 1 | AEV |
| -- | 1 | AEV |
| Bulkhead Cabinet "J": Standard | 1 | AEV |
| -- Cabinet "J": Over Att Seat | 1 | AEV |
| -- Door: Single Flip Up 3/8" Lexan | 1 | AEV |
| -- Handle: "C" Handle W/ Reel Torque Hinges & Brass Grabber | 1 | AEV |
| -- | 1 | AEV |
| < CURBSIDE GLOVE CABINET: NONE NOTE: Requires at least 72" Interior Headroom to have Glove Cabinet over C/S Entry Door ! | 1 | AEV |
| -- | 1 | AEV |
| CURBSIDE UPPER: NONE | 1 | AEV |
| -- | 1 | AEV |
| < CURBSIDE REAR: Rear of S/B, Mods Small upper at foot of Squad Bench with lexan sliding door. Re-stocking left side hinge and (2) Adj. Shelves. Add Padding around cabinet. | 1 | AEV |
| See Pics from last build | | |
| -- Cabinet L : (1) Opening with (2) Adj shelf, shelf std. | 1 | AEV |
| -- Doors, Sliding Lexan, Mitered AL Assy: Standard | 1 | AEV |
| -- Polycarbonate Handles: Full Length Extruded | 1 | AEV |
| -- Re-stocking left side hinged | 1 | AEV |
| LF Cabinet, Behind Att Seat: Cabinet "H"/(Elec Cab) | 1 | AEV |
| -- Plastic Vent: (2) Total, 1 column x 8 row, Vent 01 | 1 | AEV |
| -- Door, Single Solid Flush Fitted | 1 | AEV |
| -- TRIM: U-shaped Door, J-trim opening | 1 | AEV |
| -- Hinge Orientation: RIGHT | 1 | AEV |
| -- Hinge: 1 1/2" Stainless Steel Piano Hinge | 1 | AEV |
| -- Lever Latch: Non-locking - Black Finish | 1 | AEV |
| -- | 1 | AEV |
| RF ALS Cabinet: Standard | 1 | AEV |
| -- Cabinet I-1: Standard | 1 | AEV |

| DESCRIPTION | QTY | ID |
|---|-----|-----|
| -- Door: Single Flip Up 3/8" Lexan | 1 | AEV |
| -- Handle: "C" Handle W/ Reel Torque Hinges & Brass Grabber | 1 | AEV |
| -- | 1 | AEV |
| -- Cabinet I-2: Standard | 1 | AEV |
| -- Doors, Double Solid, Flush Fitted: W/ Lexan Insert | 1 | AEV |
| -- TRIM: U-shaped Door, J-trim opening, DBL DRS | 1 | AEV |
| -- Hinge Orientation: (1) RIGHT and (1) LEFT | 1 | AEV |
| -- Handles: "C" Handle | 2 | AEV |
| -- Brass Grabbers; as needed on door(s). | 2 | AEV |
| -- Hinge: 1 1/2" Stainless Steel Piano Hinge | 2 | AEV |
| -- Outside Access: Thru M-7 (RF) Compartment door. | 1 | AEV |
| -- Interior MICA Color: White cabinet liner | 1 | AEV |
| -- Shelf Track: 1/2" Incremental, alum | 1 | AEV |
| < -- (2) Shelves: Adjustable with J-trim | 1 | AEV |
| TOP SURFACE FINISH: Easy Grip | | |
| < -- Cabinet I-3: Standard | 1 | AEV |
| 15" Interior Height. | | |
| -- Door, Single Solid, Flush - Drug Locker | 1 | AEV |
| -- TRIM: U-shaped Door, J-trim opening | 1 | AEV |
| -- Hinge Orientation: BOTTOM | 1 | AEV |
| -- Hinge: 1 1/2" Stainless Steel Piano Hinge | 1 | AEV |
| -- Lever Latch: Locking - Black Finish | 1 | AEV |
| -- Outside Access: Thru M-7 (RF) Compartment door. | 1 | AEV |
| -- Interior MICA Color: White cabinet liner | 1 | AEV |
| Right Rear Cabinet: Cover over M-5 Compartment | 1 | AEV |
| -- | 1 | AEV |
| -- | 1 | AEV |
| SQUAD BENCH: Standard 164-172 | 1 | AEV |
| -- See Upholstery Section for Post and Wheel Cup info | 1 | AEV |
| -- Bio-waste/Sharps No 2: (DR92 style) ABS Rim, Red Lexan | 1 | AEV |
| -- LOCATION: At head of Squad Bench | 1 | AEV |
| -- SHARPS CONTAINER: 3-Quart Bemis Container | 1 | AEV |
| -- WASTE CONTAINER: AEV 6 Quart | 1 | AEV |
| -- Storage Under Lid - Configure to M-6 Compartment Size | 1 | AEV |
| -- Squad Bench Lids: Split - 2-section | 1 | AEV |
| -- Hinge, Squad Bench Lid(s): Butt Style Hinges | 1 | AEV |
| -- Latch, Squad Bench Lid(s): Slam Action Paddle, Non-loc | 2 | AEV |
| -- Lid Checks: Gas shock, Dual Action | 2 | AEV |
| -- Edge Trim, Lids: Band w/ Laminate and J-Trim Protection | 1 | AEV |
| < -- Restraint Net, Black, 7 point detachable, at head of S/B, Mod | 1 | AEV |
| Seven (7) NET Attachment Points: | | |
| Black in color. | | |
| -- | 1 | AEV |
| -- | 1 | AEV |
| TOP CABINETS, - Standard | 1 | AEV |
| -- Cabinet A: Standard | 1 | AEV |
| -- Door: Single Flip Up 3/8" Lexan | 1 | AEV |
| -- Handle: "C" Handle W/ Reel Torque Hinges & Brass Grabber | 1 | AEV |
| -- | 1 | AEV |
| < -- Cabinets B, B1, and B2: Sraight Build accross top | 1 | AEV |
| See Drawing | | |
| -- Shelf Track: 1/2" Incremental, alum | 1 | AEV |
| < -- (1) Shelf: Adjustable with Alum Trim B only | 1 | AEV |
| See Drawing | | |
| -- Doors, Sliding Lexan, Mitered AL Assy: Standard | 1 | AEV |
| -- Polycarbonate Handles: Full Length Extruded | 1 | AEV |

| DESCRIPTION | QTY | ID |
|--|----------|------------|
| -- | 1 | AEV |
| -- | 1 | AEV |
| | 1 | AEV |
| | 1 | AEV |
| -- Action Area: Extended | 1 | AEV |
| < -- A/A Tray: Color Keyed Mica with ABS BioWaste Bemis Container Cont03B Waste Container CANO-04G | 1 | AEV |
| -- Action Area Board: See Station No 6 for content | 1 | AEV |
| -- | 1 | AEV |
| -- Cabinet C: I/O access to M3 comp. | 1 | AEV |
| < -- Doors, Sliding Lexan, Mitered AL Assy: Restocking Hinged Top, Gas Shock installed to hold door open at 90 degrees. (2) slam action latches with decal "Latch Here" Labels. | 1 | AEV |
| -- Inside Access / Outside Access | 1 | AEV |
| -- | 1 | AEV |
| -- Cabinet D: Rear of A/A | 1 | AEV |
| -- Shelf Track: 1/2" Incremental, alum | 1 | AEV |
| -- (1) Shelf: Adjustable with Alum Trim | 1 | AEV |
| -- Doors, Sliding Lexan, Mitered AL Assy: Standard | 1 | AEV |
| -- Polycarbonate Handles: Full Length Extruded | 1 | AEV |
| -- | 1 | AEV |
| -- Cabinet E: Standard 1/2 depth behind M3 spare tire mount | 1 | AEV |
| -- Cabinet E1: Standard Beneath rear section of A/A Full depth | 1 | AEV |
| -- Doors, Sliding Lexan, Mitered AL Assy: Standard | 1 | AEV |
| -- Polycarbonate Handles: Full Length Extruded | 1 | AEV |
| -- No Inside Access to Exterior Compartment | 1 | AEV |
| -- | 1 | AEV |
| < -- Cabinet F: Standard Forward Section of A/A Drug Storage Locker | 1 | AEV |
| See Drawings and Pics of Last Build | | |
| -- Door, Single Solid, Flush Fitted | 1 | AEV |
| -- TRIM: U-shaped Door, J-trim opening | 1 | AEV |
| -- Hinge Orientation: RIGHT | 1 | AEV |
| -- Hinge: 1 1/2" Stainless Steel Piano Hinge | 1 | AEV |
| < -- Cam Lock (KV-70): 1/4 turn pawl - Hinged Door #LOCK-02A | 1 | AEV |
| -- | 1 | AEV |
| -- CPR Side Seat: None, See Work Order for Specifics | 1 | AEV |
| -- Cabinet O1: Standard | 1 | AEV |
| -- Door, Single Solid Flush Fitted | 1 | AEV |
| -- TRIM: U-shaped Door, J-trim opening | 1 | AEV |
| -- Hinge Orientation: RIGHT | 1 | AEV |
| -- Hinge: 1 1/2" Stainless Steel Piano Hinge | 1 | AEV |
| < -- Cam Lock (KV-70): 1/4 turn pawl - Hinged Door #LOCK-02A | 1 | AEV |
| -- | 1 | AEV |
| | 1 | AEV |
| CABINET SET - CELL 4 - MOD | 1 | AEV |
| Sub Floor, 3/4" Plywood, Standard | 1 | AEV |
| Flooring: Lonplate II - #421 Mica (Light Gray) | 1 | AEV |
| -- Flooring Main Edge: 3" Recessed (1/2" deep) roll-up | 1 | AEV |
| < -- Rear Threshold, Stainless, 6" Wide x Full Width at rear doors Install safety yellow with diagonal stripes nonskid tape over threshold. | 1 | AEV |

| DESCRIPTION | QTY | ID |
|--|-----|-----|
| -- C/S Stepwell Threshold, Polished Diamond Plate | 1 | AEV |
| -- | 1 | AEV |
| COT MOUNT HARDWARE: (Full Size Mod) | 1 | AEV |
| -- | 1 | AEV |
| < -- Cot Mount: Stryker, No 6390, Power Load, Floor Prep ONLY | 1 | AEV |
| This will have everything need for Customer/Dealer to install the Stryker Power Load system at a later date. | | |
| THIS DOES NOT INCLUDE ANY COT MOUNT | | |
| -- Add'l Cot Mount for Power Load: NONE | 1 | AEV |
| < -- Cot Position No 1: PRIMARY CENTER POSITION, (Power Load Prep) Maintain 12" between Cot and S/B. | 1 | AEV |
| NOTE: AEV WILL NOT INSTALL ANY COT MOUNT WE WILL JUST PROVIDE FLOOR STRUCTURE FOR DEALER TO INSTALL POWER LOAD FROM OLD UNIT. | | |
| < -- Primary Cot position under floor reinforcement | 1 | AEV |
| Install 8 inch wide by 5 foot long 1/2" aluminum reinforcement at primary cot position. Location is shown on floor print at Primary cot position ONLY. Only one main plate per unit. | | |
| -- | 1 | AEV |
| -- Q Straint System: NONE | 1 | AEV |
| Hanging Hardware: NONE | 1 | AEV |
| OXYGEN / AIR / VACUUM System: | 1 | AEV |
| < -- Oxygen Outlet No 1: Amico Console - Ohio Diamond Style AEV Part No: OUTL-AOB | 1 | AEV |
| -- LOCATION: Action Area | 1 | AEV |
| -- | 1 | AEV |
| -- Oxygen Outlet No 2: Amico Console - Ohio Diamond Style | 1 | AEV |
| -- LOCATION: Action Area | 1 | AEV |
| -- | 1 | AEV |
| -- Oxygen Outlet No 3: Amico Console - Ohio Diamond Style | 1 | AEV |
| -- LOCATION: Curbside Wall, over the head of the S/B | 1 | AEV |
| -- | 1 | AEV |
| < -- Rack No 1: M/H cylinder, AEV, Aluminum w/ (2) Pull Straps Stra-02036 Pull Straps | 1 | AEV |
| -- Neck Strap: Connected to top strap of bottle rack | 1 | AEV |
| < -- Cylinder Type: OXYGEN - Green Colored Hose Regulator connection Nut: 9/16" RH thread. | 1 | AEV |
| -- Rack Location: Left Front, wall #2 near wall #3 | 1 | AEV |
| -- Regulator Wrench: Cast aluminum, OXYGEN w/ cable lanyard | 1 | AEV |
| -- Vacuum System: SSCOR regulator/gauge panel in A/A | 1 | AEV |
| < -- Collection Canister: Bemis, 1200 CC Capacity LOCATION: Below Action Area, See A/A discription. | 1 | AEV |
| -- VAC Plumbing: Direct from panel to canister - NO Outlet | 1 | AEV |
| < -- Vacuum Pump: 49 State AEV Part No: PUMP-02LK AEV Part No: PLAT-05 AEV Part No: Mounts = BUMP-01L (3) | 1 | AEV |
| -- Location: M-1a Compartment | 1 | AEV |
| -- PORTABLE SUCTION UNIT : NONE | 1 | AEV |
| P6 - 6-Point Restraint System - with CPR Seat | 1 | AEV |
| -- (2) on Squad Bench, (0) CPR Side Seat | 1 | AEV |
| -- Squad Bench: (0) seating positions for 2-point, LAP, ALR | 1 | AEV |

| DESCRIPTION | QTY | ID |
|---|-----|------------|
| -- S/B: (3) Sec patient restraints - 9" Sleeves Face of Bench | 1 | AEV |
| -- S/B: (3) Sec patient restraints - 5" Sleeves By Hinge | 1 | AEV |
| -- CPR Side Seat: (0) seating positions, CPR Seat Deleted | 1 | AEV |
| -- | 1 | AEV |
| TRIM / DOOR ASSEMBLY - CELL 5 | 1 | AEV |
| -- Soft Touch Trim Kit: None | 1 | AEV |
| *****DOOR DEPARTMENT - Full Mod***** | 1 | AEV |
| -- Handles, Ext: Tri-mark 030-1875, Free Float, Polished CNNC finish | 1 | AEV |
| -- Emergency Access Interior Release: NONE | 1 | AEV |
| < -- Grab Rail, (1), 18" Gray Antimicrobial Rear Entry Assist std. AEV Part No: RAIL-BK18EF Located : Module interior at the rear entry, mounted to the M5 compartment filler. Rail is to be through bolted into M5. | 1 | AEV |
| Entry Door Panels, Windows and Hardware | 1 | AEV |
| -- Interior Grab Handle Color: Gray Antimicrobial | 1 | AEV |
| -- Grab Handle, CS Entry: 1 1/4" Dia..... S/S, 2-pt 18"L, Gray Antimicrobial | 1 | AEV |
| -- Grab Handles, Rear Access: (2) 12"L X 1 1/4" Dia..... S/S, 2-pt, Gray Antimicrob | 1 | AEV |
| -- Door Panels: Diamond Plate / Upholstery / Diamond Plate | 1 | AEV |
| -- Curbside Lower Door Panel: Diamond Plate | 1 | AEV |
| -- UPPER Windows: RA Doors, Fixed Glass 17.3"W x 19.3"H | 1 | AEV |
| -- UPPER Window: CS Access, Fixed Glass, std tint | 1 | AEV |
| < Walk through Door: Slide behind drivers seat fixed window Door Hardware: Extruded Aluminum Track - Top and Bottom. | 1 | AEV |
| -- | 1 | AEV |
| ELECTRICAL Point to Point - CELL 6 | 1 | AEV |
| -- Map Light : None | 1 | AEV |
| < Action Area Light: 12V, LED, Surface Mount aev Lite-I29 | 1 | AEV |
| -- Light Location: Action Area | 1 | AEV |
| Extended Action Area Light: 12V, LED, Surface Mount | 1 | AEV |
| -- Light Location: Bottom of Cabinet C | 1 | AEV |
| Cabinet Interior Lights: None | 1 | AEV |
| UPHOLSTERY - CELL 7 | 1 | AEV |
| Upholstery Color: Light Gray (Dove) | 1 | AEV |
| -- Center Trough Upholstery Color: Color Key to Rest of Truck | 1 | AEV |
| -- | 1 | AEV |
| Uph Joint Type: Vacuum Formed - Seamless | 1 | AEV |
| Squad Bench seat cushion cut-outs: None | 1 | AEV |
| Head Protection: Pad over CS Entry Door | 1 | AEV |
| Head Protection: 2" Pad over Rear Access Doors, Full Width | 1 | AEV |
| PAINT - STRIPES - DECALS | 1 | AEV |
| -- Undercoating : Per QVM Guidelines, STD | 1 | AEV |
| Ford OEM White entire unit | 1 | AEV |
| Reflective Tape: On painted edges of Exterior Door Frame | 1 | AEV |
| Compartment Finish: Diamond Plate Standard | 1 | AEV |
| Primary (Over All) Color: White (YZ) | 1 | AEV |

| DESCRIPTION | QTY | ID |
|--|-----|------------|
| < -- Flip Step Reflective/Prismatic Tape: Red/White/R/W/R/W/R Install on rearward facing edge of flip up step at rear module entry. AEV Tape-RS | 1 | AEV |
| -- Tape Stripe: NONE (KKK-F Deviation) | 1 | AEV |
| < -- Roof Paint: Color and finish quality to be GLOSSY The roof shall be painted, with a glossy finish, but not sanded and buffed. | 1 | AEV |
| Special Striping: Chevron Items: Dealer Installed | 1 | AEV |
| Lettering: Dealer Installed | 1 | AEV |
| < Drip Rails: Bright Aluminum, De-burred and rounded corners Pack and SHIP LOOSE | 1 | AEV |
| Include a drip rail over the C/S Entry Door. | | |
| DETAIL - SHIP LOOSE ITEMS | 1 | AEV |
| < -- Drip Rails: Detail-Refer to Paint Section for Drip Rail Information Include a drip rail over the C/S Entry Door. | 1 | AEV |
| -- Owner's Manual DVD ship loose | 1 | AEV |
| -- Amico O2 Minder, Transducer: NONE | 1 | AEV |
| Decals: KKK / DOT Pkg, Blue/White reflective - Ship Loose | 1 | AEV |
| -- Decals: 32" Star of Life - Ship Loose | 1 | AEV |
| Decals: NO SMOKING & SEATBELT, installed, cab & pt. area. | 1 | AEV |
| AEV Logos: Installed on unit per AEV standard locations | 1 | AEV |
| < Fire Extinguisher, 5 pound, shipped loose, Std AEV Part No: EXTI-01 | 1 | AEV |
| < Reflector Pkg: Body - 2ea, Side Fr Amber, Side Re Red, Rear Stick-on reflectors: Peterson "Spitfire" B484R and B484A LOCATIONS: In lower corners of module (2) - (1) each side and Front - AMBER (2) - (1) each side and Rear - RED (2) - On Rear of body - RED | 1 | AEV |
| STD Regulator, Oxygen, Fixed output @ 50 psi +/-5 , CGA 540, Ship Loose | 1 | AEV |
| Post And Wheel Cups: NONE | 1 | AEV |
| Spare Tire: Refer To Chassis Section to See if it gets one. | 1 | AEV |
| Primary Cot: NONE included | 1 | AEV |
| Secondary Stretcher: NONE included | 1 | AEV |
| < Indemnification Statement The purchaser agrees to defend, indemnify and hold AEV harmless from any claims, costs (including actual attorneys' fees), damages and liabilities caused in whole or in part by any alteration or modification of, or changes or additions to the Purchased Products OR use of product for purposes it was not designed or intended for. | 1 | AEV |
| == 172x95 T-3 G4500 14,200 Base Price - 0.000 02/07/11 == | 1 | AEV |
| GENERAL CONVERSION | 1 | AEV |
| 2015 **164 T-3** G4500 Chev/GMC Std Spec&CONV PKG - 15-1 (2015 chassis) | 1 | AEV |
| | 1 | AEV |
| -- ***END OF ORDER*** | 1 | AEV |

CONCEPTUAL DRAWINGS ONLY: DRAWINGS ARE NOT TO SCALE, DIMENSIONS ARE APPROXIMATE & SUBJECT TO ENGINEERING CHANGE

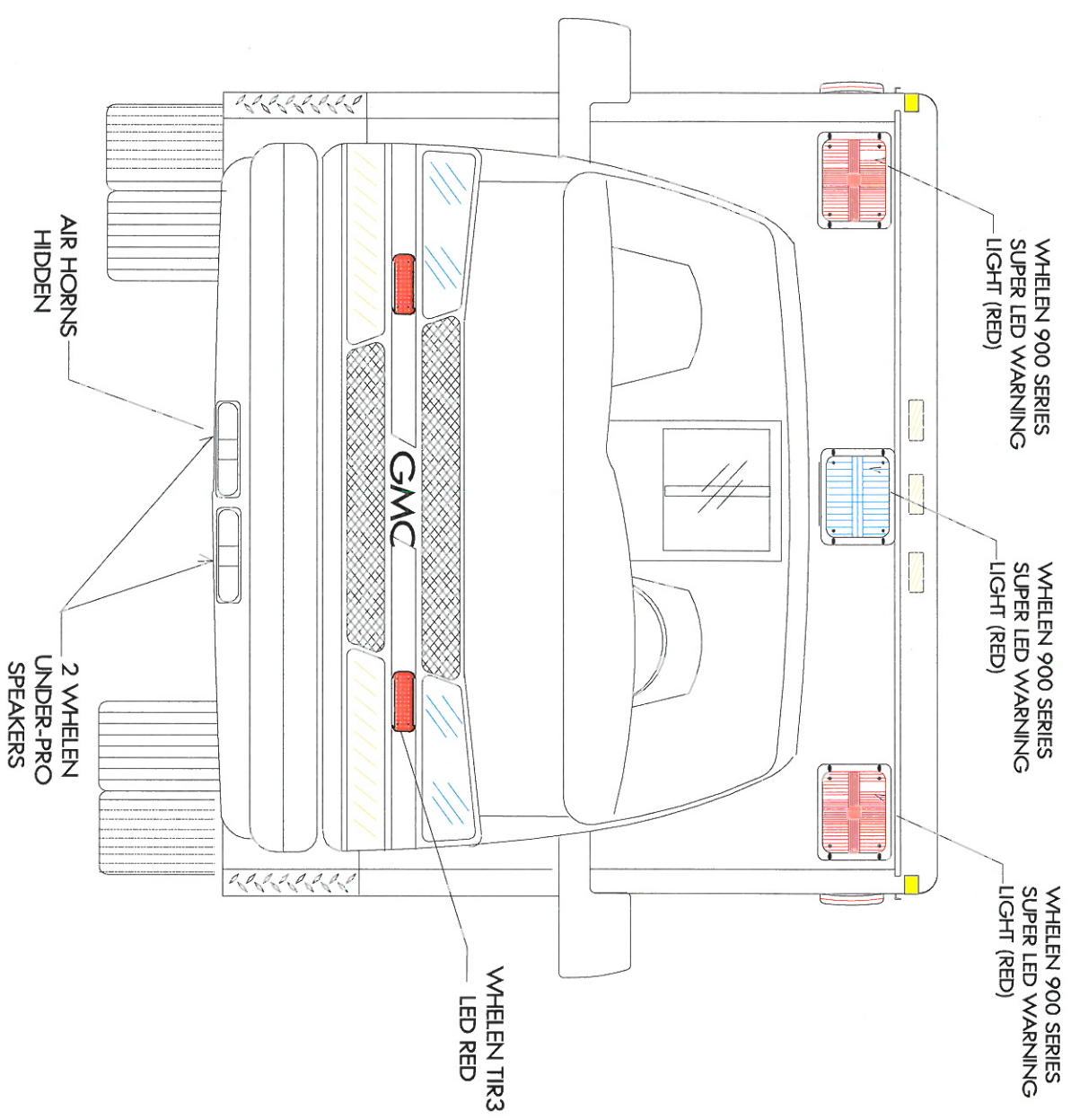

| Compartment Dimensions | | | |
|------------------------|--------|--------|-------|
| Comp | Height | Width | Depth |
| M1A | 17.56" | 18.6" | 19.4" |
| M1 | 79.8" | 18.6" | 19.4" |
| M2 | 31.5" | 44.5" | 19.4" |
| M3 | 58.5" | 33.1" | 19.4" |
| M5 | 79.8" | 17.6" | 21" |
| M7 | 46.6" | 25.25" | N/A |
| Battery | 12.1" | 25.25" | 21.4" |

AMERICAN EMERGENCY VEHICLES
 TITLE: EXT. FRONT
 CHEVY G-4500 TYPE III
 DWG # _____ REV # _____
 TRUCK# PROPOSAL _____
 BY: EDDIE DATE: 2/23/15
 BODY # _____



CONCEPTUAL DRAWINGS ONLY. DRAWINGS ARE NOT TO SCALE, ALL MEASURES ARE APPROXIMATE & SUBJECT TO ENGINEERING CHANGE

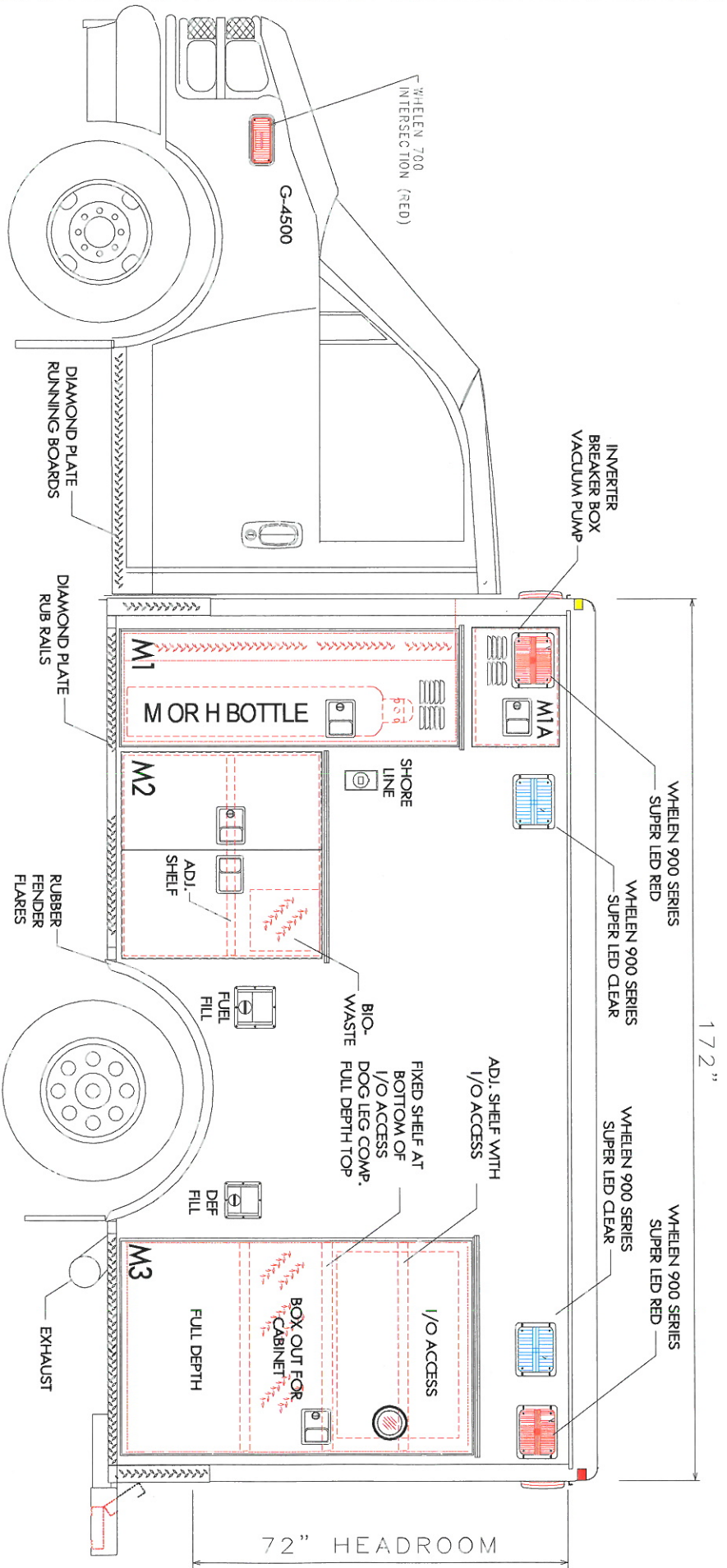

| Compartment Dimensions | | | |
|------------------------|--------|--------|-------|
| Comp | Height | Width | Depth |
| M1A | 17.56" | 18.6" | 19.4" |
| M1 | 79.8" | 18.6" | 19.4" |
| M2 | 31.5" | 44.5" | 19.4" |
| M3 | 58.5" | 33.1" | 19.4" |
| M5 | 79.8" | 17.6" | 21" |
| M7 | 46.6" | 25.25" | N/A |
| Battery | 12.1" | 25.25" | 21.4" |

AMERICAN EMERGENCY VEHICLES

TITLE: EXT SS

CHEVY G-4500 TYPE III

DWG # _____ REV# _____

TRUCK# PROPOSAL _____ DATE: 2/25/15

BY: EDDIE _____ BODY # _____



CONCEPTUAL DRAWINGS ONLY: DRAWINGS ARE NOT TO SCALE, ALL MEASURES ARE APPROXIMATE & SUBJECT TO ENGINEERING CHANGE

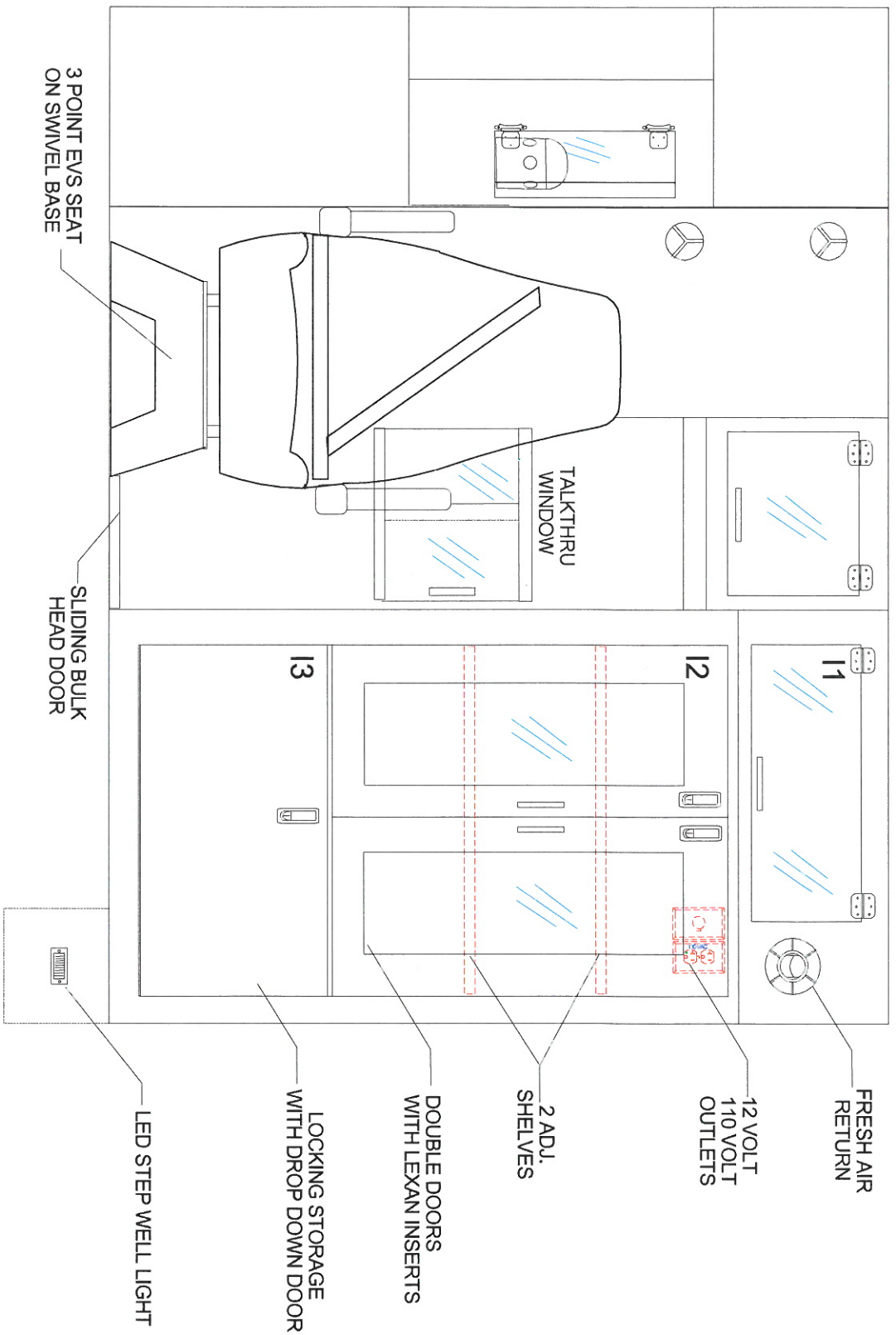

AMERICAN EMERGENCY VEHICLES

TITLE: INTERIOR FRONT

CHEVY G-4500 TYPE III

DWG # REV #

TRUCK# PROPOSAL

BY: EDDIE DATE: 2/28/15

BODY #



KEY LARGO

CONCEPTUAL DRAWINGS ONLY. DRAWINGS ARE NOT TO SCALE, ALL MEASURES ARE APPROXIMATE & SUBJECT TO ENGINEERING CHANGE

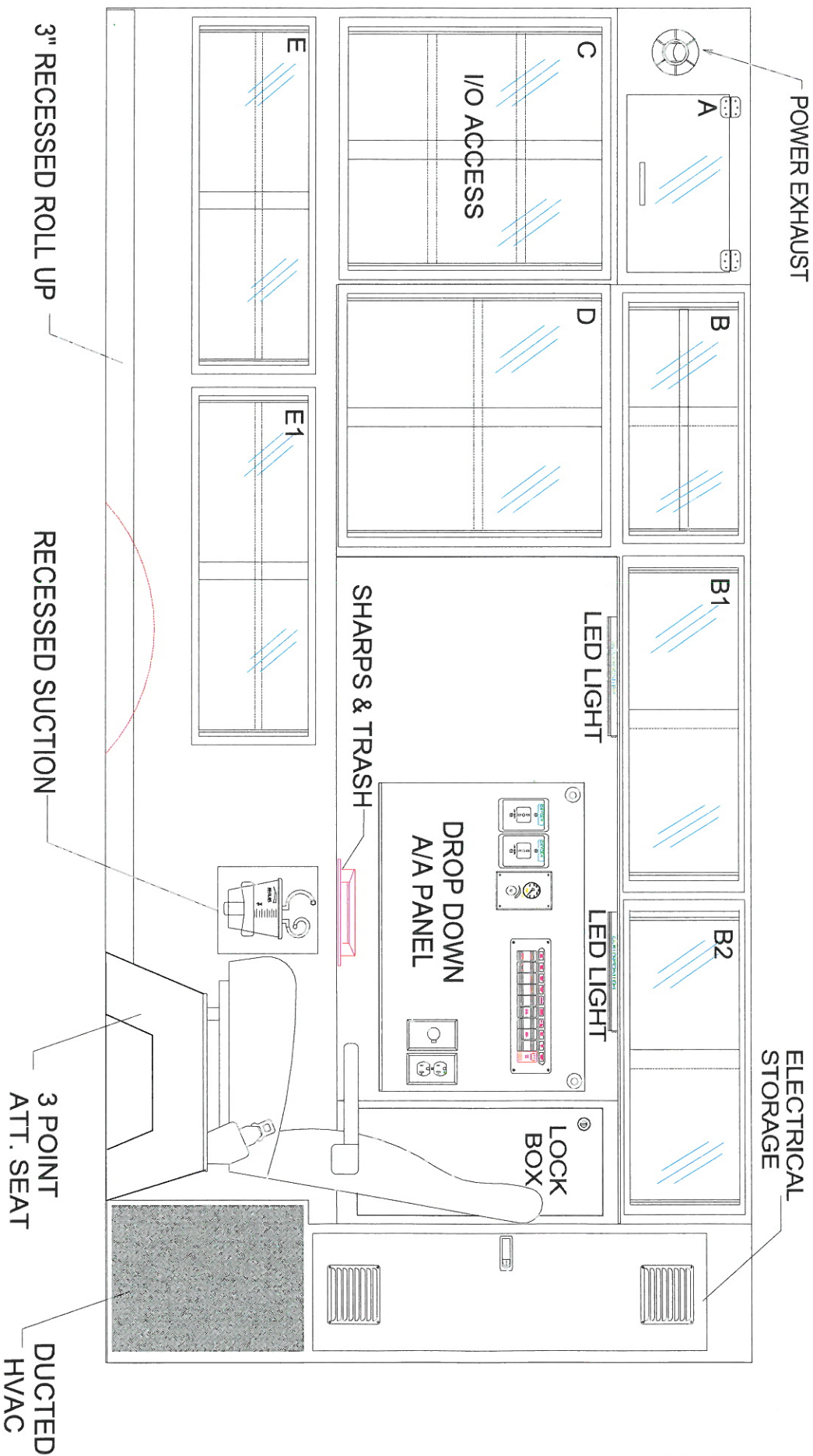

AMERICAN EMERGENCY VEHICLES

TITLE: INT. SS

CHEVY G-4500 TYPE III

DWG.# REV.#

TRUCK# PROPOSAL

BY: EDDIE DATE: 2/28/15

BODY #:



KEY LARGO

CONCEPTUAL DRAWINGS ONLY. DRAWINGS ARE NOT TO SCALE. ALL MEASURES ARE APPROXIMATE & SUBJECT TO ENGINEERING CHANGE

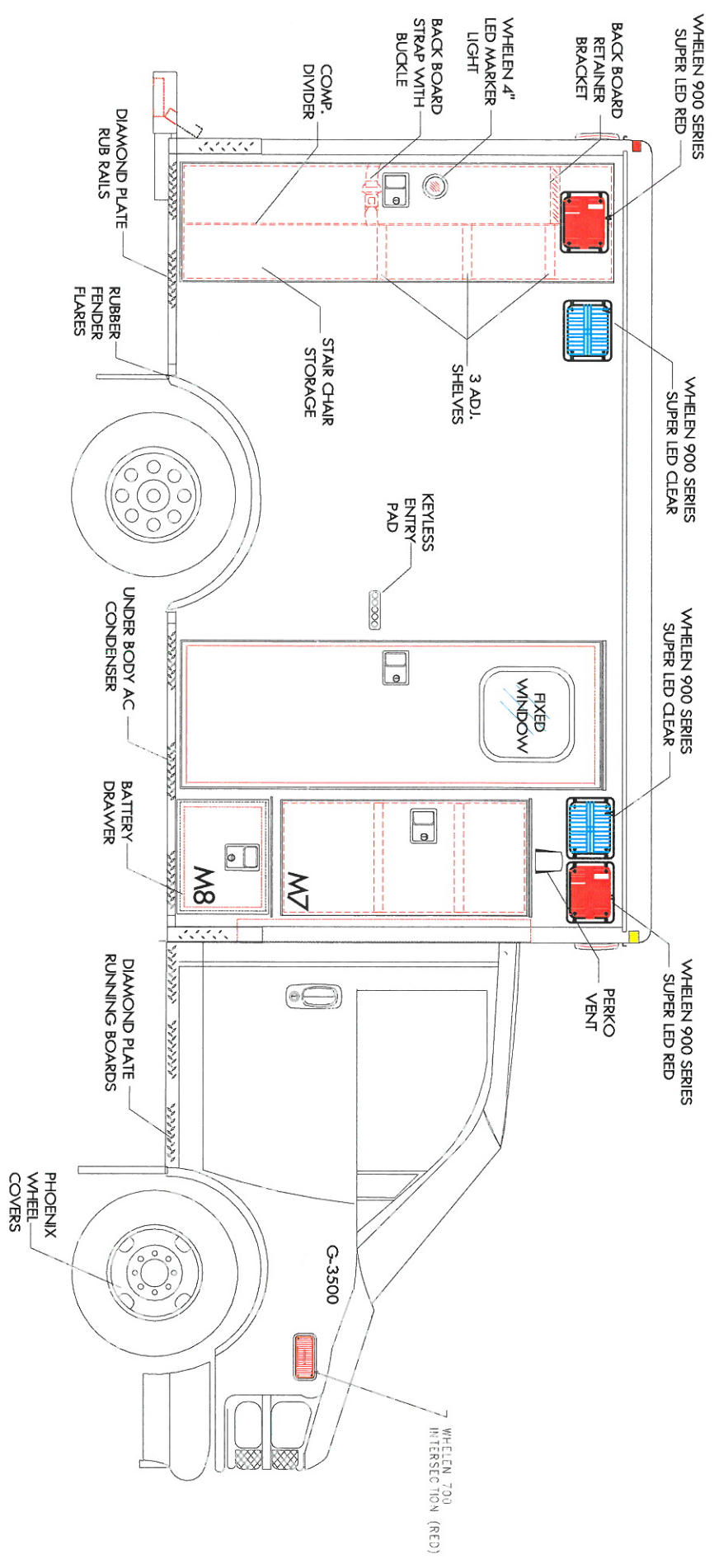

Compartment Dimensions

| Comp | Height | Width | Depth |
|---------|--------|--------|-------|
| M1A | 17.56" | 18.6" | 19.4" |
| M1 | 79.8" | 18.6" | 19.4" |
| M2 | 31.5" | 44.5" | 19.4" |
| M3 | 58.5" | 33.1" | 19.4" |
| M4 | 79.8" | 17.6" | 21" |
| MV | 46.6" | 25.25" | N/A |
| Battery | 12.1" | 25.25" | 21.4" |



AMERICAN EMERGENCY VEHICLES

TITLE: EXT. CS
 CHEVY G-4500 TYPE III
 DWG # _____ REV # _____
 TRUCK# PROPOSAL _____ DATE: 2/25/15
 BY: EDDIE
 BODY # _____



CONCEPTUAL DRAWINGS ONLY. DRAWINGS ARE NOT TO SCALE, ALL MEASURES ARE APPROXIMATE & SUBJECT TO ENGINEERING CHANGE

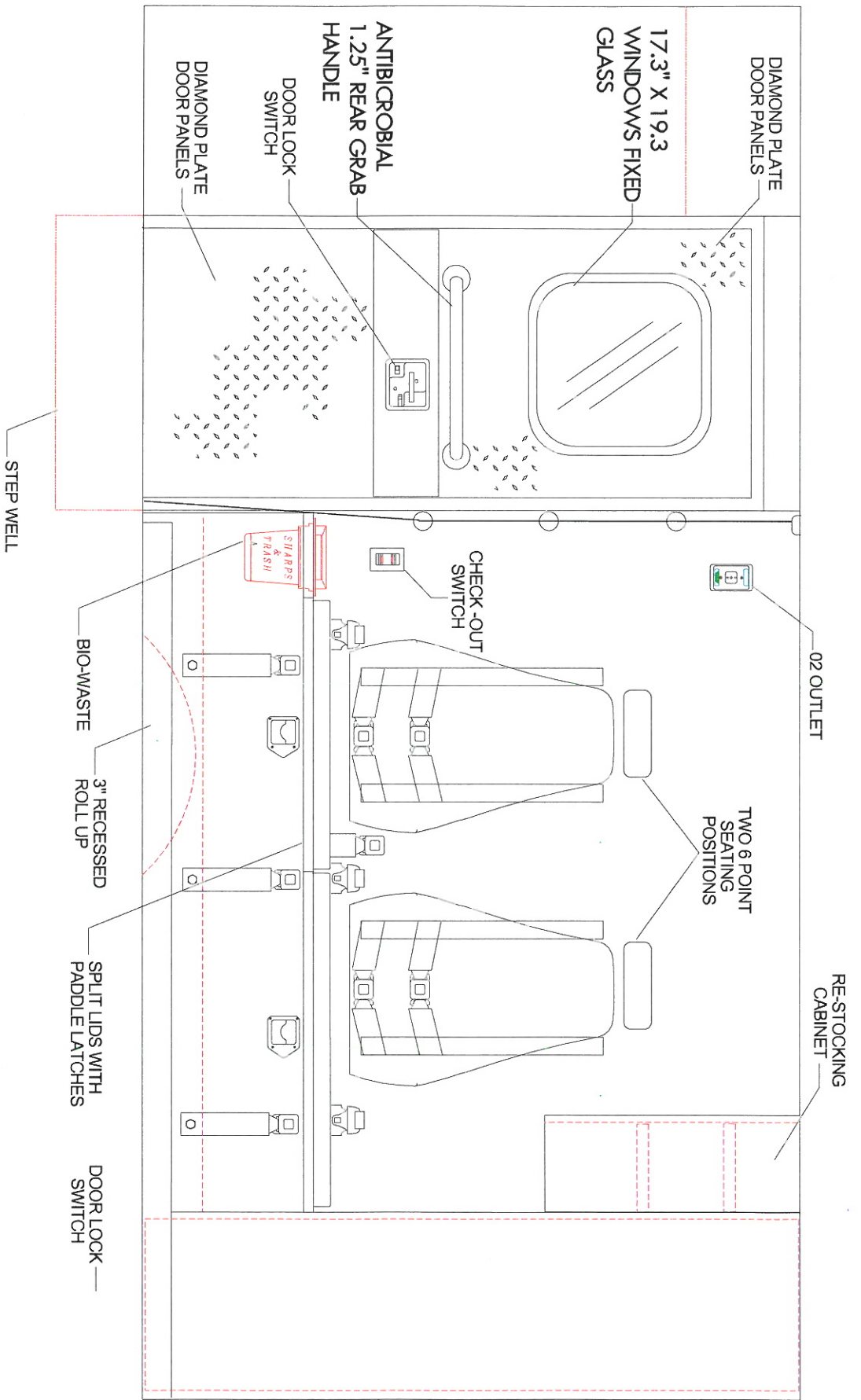

AMERICAN EMERGENCY VEHICLES

| | |
|-----------------------|---------------|
| TITLE: INTERIOR CS | |
| CHEVY G-4500 TYPE III | |
| DWG # | REV # |
| TRUCK# PROPOSAL | DATE: 2/28/15 |
| BY: EDDIE | |
| BODY # | |



CONCEPTUAL DRAWINGS ONLY; DRAWINGS ARE NOT TO SCALE, ALL MEASURES ARE APPROXIMATE & SUBJECT TO ENGINEERING CHANGE

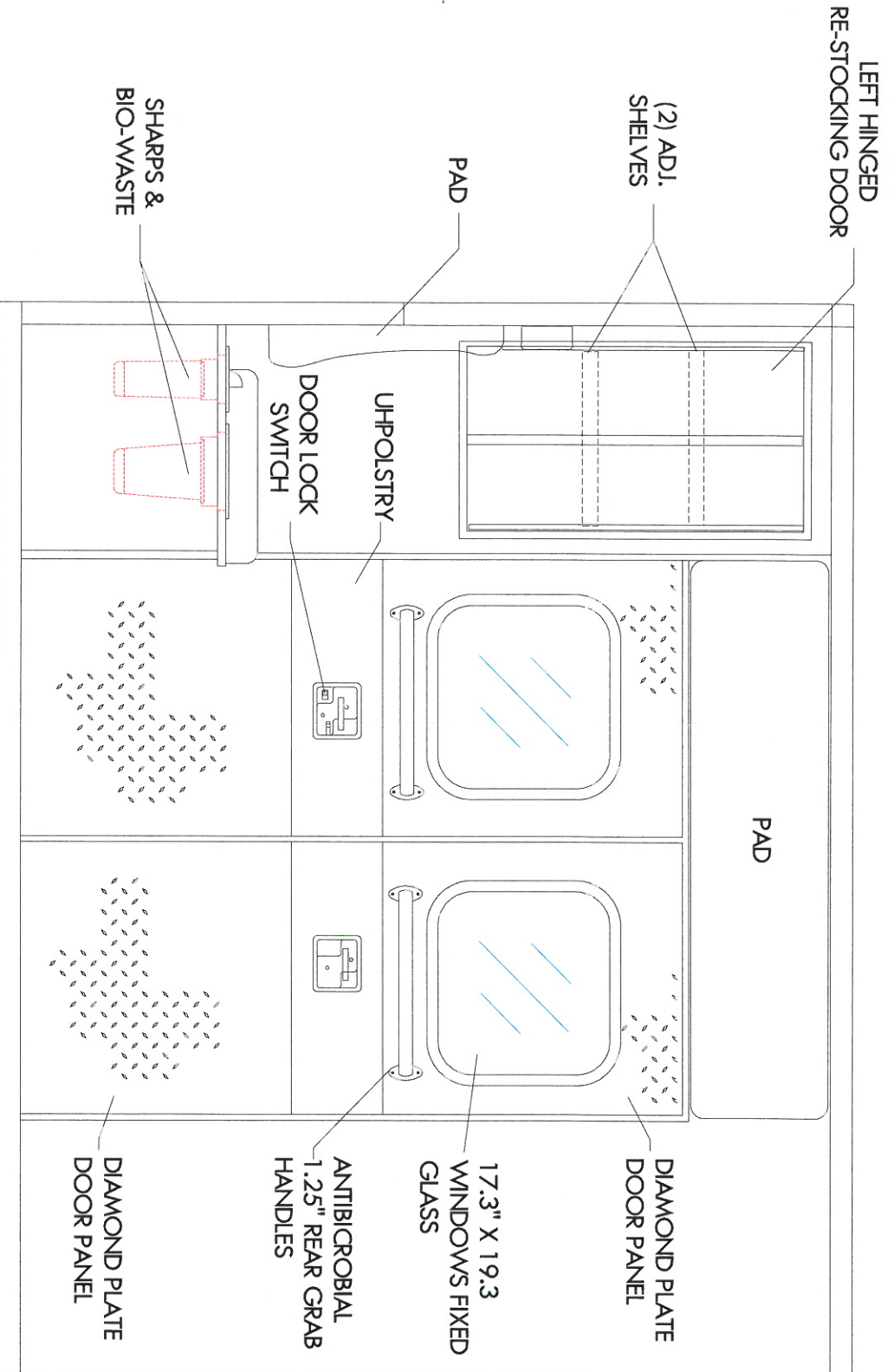

AMERICAN EMERGENCY VEHICLES

TITLE: INTERIOR REAR

CHEVY G-4500 TYPE III

DWG.# REV.#

TRUCK# PROPOSAL

BX EDIE DATE: 2/25/15

BODY #



2025/02/25/15

KEY LARGO